

ORDINANCE NO. BG2019 - 16

ORDINANCE ANNEXING RIGHT-OF-WAY BY CONSENT

ORDINANCE ANNEXING 20.51 ACRES OF
RIGHT-OF-WAY LOCATED ON VETERANS
MEMORIAL LANE AND MORGANTOWN ROAD,
PRESENTLY OWNED BY THE
COMMONWEALTH OF KENTUCKY
TRANSPORTATION CABINET WITH SAID
TERRITORY BEING CONTIGUOUS TO
EXISTING CITY LIMITS

WHEREAS, pursuant to KRS 81A.412, the City of Bowling Green may annex any area which meets the requirements for annexation if the owner of record of the land to be annexed gives prior consent in writing; and,

WHEREAS, the Commonwealth of Kentucky Transportation Cabinet has requested and consented in writing to the annexation of 20.51 acres of right-of-way located on Veterans Memorial Lane (U.S. 68) and Morgantown Road (U.S. 231), from Stonehenge Drive to approximately 275 feet north of Morgantown Road and along Morgantown Road from approximately 124 feet west of Veterans Memorial Lane to approximately 750 feet east of Veterans Memorial Lane; and,

WHEREAS, the City of Bowling Green hereby declares it desirable to annex the right-of-way as described in the attachments to this Ordinance; and,

WHEREAS, the proposed right-of-way to be annexed is adjacent or contiguous to the City; and,

NOW, THEREFORE, BE IT ORDAINED by the City of Bowling Green, Kentucky pursuant to KRS 81A.412 as follows:

1. The right-of-way presently owned by the Commonwealth of Kentucky Transportation Cabinet located on Veterans Memorial Lane and Morgantown Road, containing 20.51 acres of right-of-way, which right-of-way is identified on the attached map and further described in the attachments to this Ordinance, all of which is contiguous to existing city limits, shall be and is hereby annexed into the City of Bowling Green, Kentucky by consent of the owner, and the boundaries of the City are hereby

(Ordinance No. BG2019 – 16)

extended so as to include and incorporate all of this right-of-way into the City of Bowling Green.

2. A copy of this Ordinance shall be forwarded to the Public Works Department, Planning and Design Division and it is hereby authorized and directed to make the necessary changes to the territorial limits of the City in Chapter One of the City of Bowling Green Code of Ordinances to reflect this annexation.

3. The provisions of this Ordinance are hereby declared to be severable, and if any section, phrase or provision shall for any reason be declared invalid, such declaration of invalidity shall not affect the validity of the remainder of this Ordinance.

4. All prior Municipal Orders or Ordinances or parts of any Municipal Order or Ordinance in conflict herewith are hereby repealed.

5. This Ordinance is adopted pursuant to KRS 83A.060 in that it was introduced on April 16, 2019, and given final reading on May 7, 2019, and said Ordinance shall be in full force and effect upon signature, recordation and publication in summary pursuant to KRS Chapter 424.

ADOPTED: May 7, 2019

APPROVED: Bruce Wilkerson
Mayor, Chairman of Board of Commissioners

ATTEST: Ashley Jackson
City Clerk

SPONSORED BY: Jeffery B. Meisel, City Manager, 04/09/2019, 9:30 a.m.

LINE	BEARING	DISTANCE
L 1	S 00°23'04"W	134.59
L 2	S 82°47'06"W	287.11
L 3	S 85°57'18"W	222.13
L 4	N 13°22'49"E	25.57
L 5	S 89°25'19"W	240.21
L 6	S 17°52'01"W	128.23
L 7	S 00°59'00"W	530.08
L 8	S 03°35'58"W	295.17
L 9	S 08°23'50"E	111.80
L 10	S 07°45'49"W	195.02
L 11	S 00°57'18"E	121.85
L 12	S 00°57'18"E	78.30
L 13	S 01°54'27"W	280.00
L 14	S 02°10'41"E	380.89
L 15	S 13°13'06"W	182.97
L 16	S 02°28'50"W	316.02
L 17	N 01°54'27"E	116.00
L 18	N 04°11'53"E	250.20
L 19	N 00°57'18"W	500.62
L 20	N 04°48'12"E	600.75
L 21	N 00°22'59"W	250.20
L 22	N 03°49'00"E	150.08
L 23	N 00°22'59"W	250.20
L 24	N 08°26'53"E	280.80
L 25	N 04°58'07"W	261.73
L 26	N 77°08'42"W	182.28
L 27	N 05°33'53"E	136.51
L 28	S 89°21'40"E	123.77
L 29	N 12°08'50"E	183.27
L 30	N 07°47'07"E	92.85
L 31	S 75°28'10"E	210.47
L 32	S 05°17'38"E	205.69
L 33	S 36°52'37"E	35.63
L 34	N 88°15'14"E	98.78
L 35	N 00°42'45"E	15.00
L 36	S 89°43'31"E	178.65
L 37	S 00°00'00"E	5.00
L 38	S 89°43'11"E	275.96
L 39	S 87°59'29"E	123.99
L 40	S 83°38'19"E	118.92
L 41	N 88°05'33"W	236.84

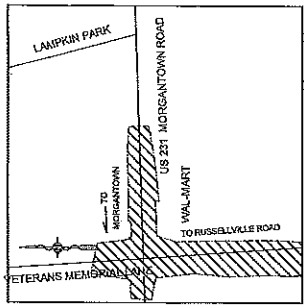
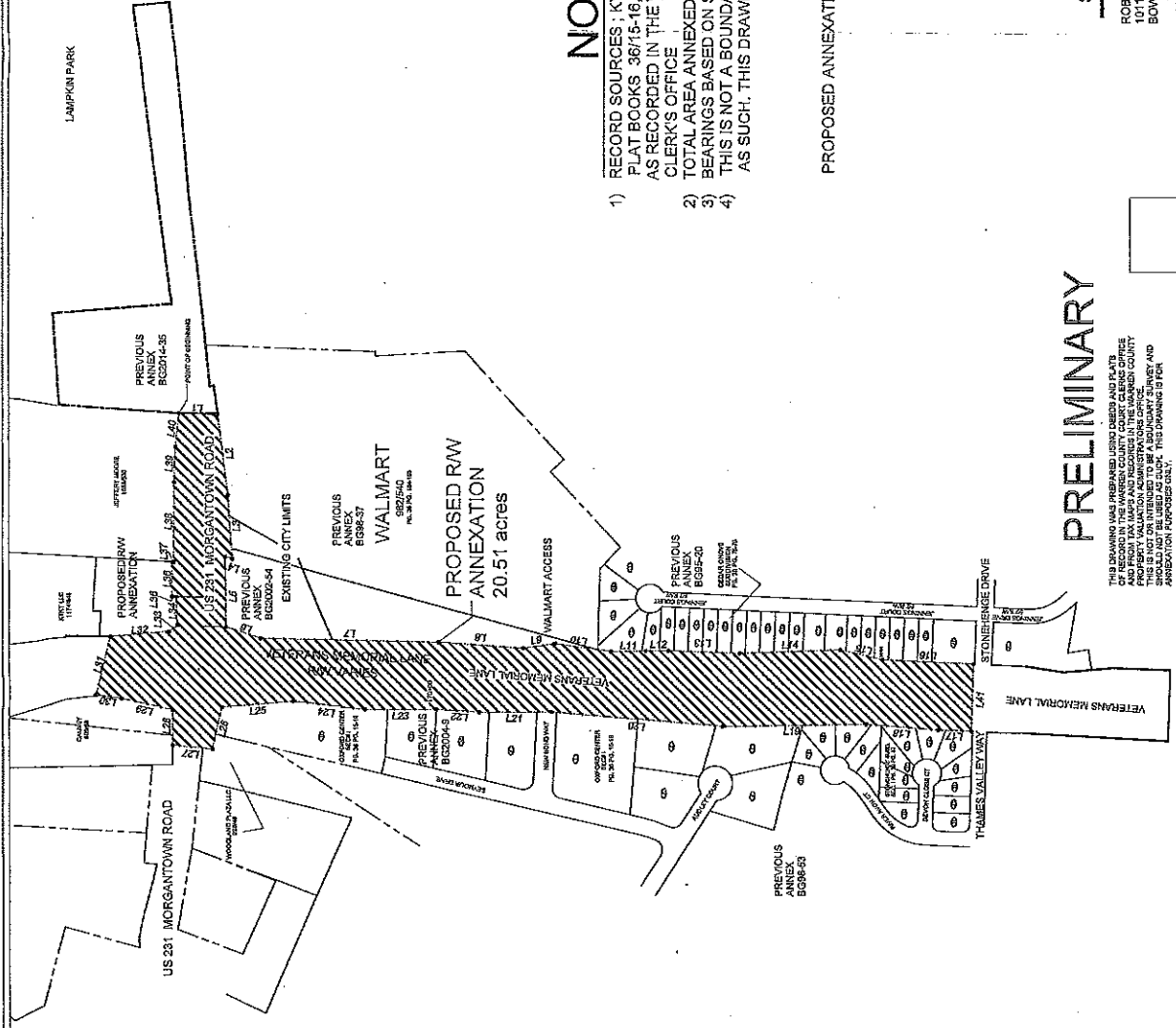
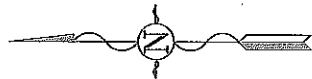

VICINITY MAP
NOT TO SCALE

NOTES

- 1) RECORD SOURCES: KYTC PROJECT SSP 114-7613 PLAT BOOKS 36715-16, 2875-76, 36164-165 AS RECORDED IN THE WARREN COUNTY COURT CLERK'S OFFICE
- 2) TOTAL AREA ANNEXED 20.51 ACRES. ALL ANNEXATION IS RAW BEARINGS BASED ON STATE PLANE KENTUCKY SOUTH 1602
- 3) THIS IS NOT A BOUNDARY SURVEY AND SHOULD NOT BE USED AS SUCH. THIS DRAWING IS FOR ANNEXATION PURPOSES ONLY.



PROPOSED ANNEXATION =

PRELIMINARY

THIS DRAWING WAS PREPARED USING DEEDS AND PLATS OF RECORD IN THE WARREN COUNTY COURT CLERK'S OFFICE PROPERTY VALUATION ADMINISTRATOR'S OFFICE. THIS DRAWING IS FOR ANNEXATION PURPOSES ONLY AND SHOULD NOT BE USED AS SUCH. THIS DRAWING IS FOR ANNEXATION PURPOSES ONLY.

ROBERT S. EVANS PLS # 3320 DATE

SURVEYOR
ROBERT S. EVANS PLS # 3320
1011 COLLEGE STREET
BOWLING GREEN, KENTUCKY 42101
PHONE # (270) 393-3229
e-mail - rob.evans@bory.org

CLIENT
CITY OF BOWLING GREEN
1001 COLLEGE STREET
BOWLING GREEN, KENTUCKY 42101
PHONE # (270) 393-3000