

# KEREIAKES PARK COMMUNITY GARDEN PLOTS

Revised - December 2008  
1" = 100'  
NOTE:  
No Water Access

31 Full Plots = \$20 each  
30' x 60'  
21 Small Plots = \$15 each  
30' x 30'  
\*Limit 2 per household

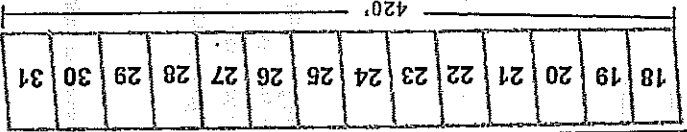
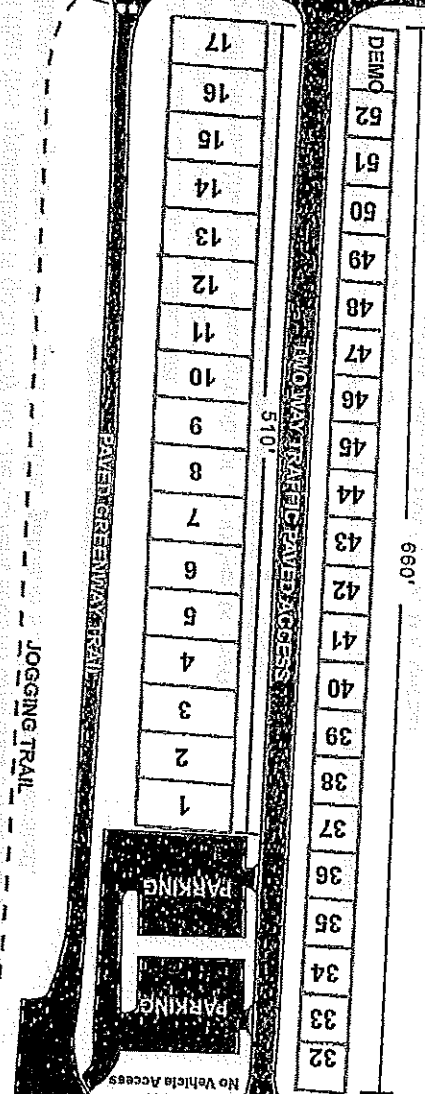
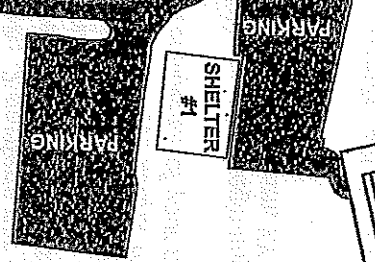
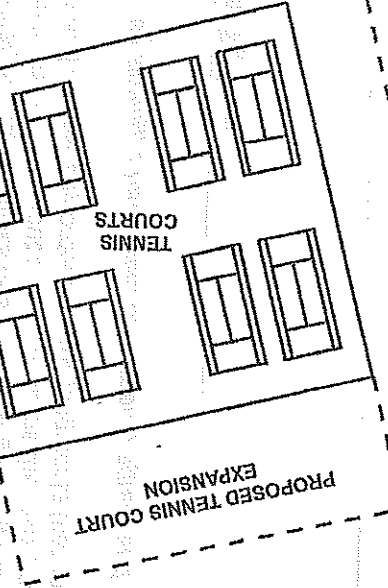

No Vehicle Access  
Bollards

No Vehicle Access  
Bollards

JOGGING TRAIL

GREENWAY TRAIL

JOGGING TRAIL

Created by  
The Trustees - 2008  
City of Berkeley  
Urban Division



**2010 COMMUNITY GARDEN PLOT APPLICATION**

I hereby apply to make use of the city garden plot(s) listed below for the current garden season at Kereiakes Park. I understand that this application is good only for the current season and that I must reapply annually. I understand that misuse of the garden and disregard for other gardeners will not be tolerated.

**TERMS OF AGREEMENT:**

1. The Parks and Recreation Department Shall:
  - a. Plow, disk and mark off gardens.
  - b. Mow all gardens that have weed growth of 24 inches or more.
  - c. **Not assume any responsibility for theft from gardens.**
2. The Gardeners Shall:
  - a. All city, state, and federal laws, statutes, ordinances, and policies must be obeyed.
  - b. Maintain the garden in good condition.
  - c. Notify Parks & Recreation if she/he decides not to use the garden.
  - d. Pay registration fee of \$20 each for full plots (30x60) or \$15 each for small plots (30x30).  
**Limit: 2 gardens per household**
  - e. Have everything removed from the gardens by November 9, so that the gardens can be plowed under for the winter.
  - f. **Weather permitting** gardens will be ready by March 31.
  - g. Do not remove and/or move the stakes.
  - h. Be considerate of your neighbor.

Plots will be available for rental beginning **March 1, 2010 on a first come basis** at BG Parks and Recreation Office, 225 E. Third Avenue, Bowling Green, KY 42101. Questions contact BGPR at 270.393.3249.

**Release and Waiver Statement:**

The responsible party/renter agrees to waive, release, absolve, indemnify, and to hold harmless the Bowling Green Parks and Recreation Department's employees, City of Bowling Green, its officials, employees from and against any and all claims, suits, actions, damages and/or causes of action arising during the term of this agreement, for any personal injury, loss of life, and liability incurred in and about any such claims the investigation thereof of the defense of any action process brought thereon and against any orders and/or judgments that may be entered therein.

*By signing, I have read, understand, agree, and will abide by this policy.*

Responsible Party/Renter Signature \_\_\_\_\_

Date \_\_\_\_\_

Print Legibly.

Name \_\_\_\_\_

Address \_\_\_\_\_

City \_\_\_\_\_ State \_\_\_\_\_ ZIP \_\_\_\_\_

Home Phone \_\_\_\_\_ Work Phone \_\_\_\_\_

Email Address: \_\_\_\_\_

**OFFICE USE ONLY**

Garden Assignment(s) - **Limit: 2 gardens per household**

# \_\_\_\_\_ Fee: \$ \_\_\_\_\_ # \_\_\_\_\_ Fee: \$ \_\_\_\_\_

Date Received/Paid \_\_\_\_\_ Receipt # \_\_\_\_\_ By: \_\_\_\_\_ #343069